

# PALACE GROUP PORTFOLIO



# CONTENTS

ABOUT US	3 - 8
PROJECTS	9 - 117
CONTACT US	118 - 119

# ABOUT US



## JOURNEY & LEGACY



As the UAE's leading general contractor, we are world-class specialists driven by innovation and efficiency in our relentless pursuit of the extraordinary.

Palace Group excels in offering a range of construction services and creating tailored luxury properties that ignite aspirations and exemplify true excellence. Our unwavering commitment to achieve client satisfaction underscores our dedication to deliver the highest quality services across diverse construction sectors.

## MISSION



We're a distinguished Group, renowned for our dedication to exceptional work and integrity. At Palace Group, we continually enhance product quality, deliver client value through innovation, foresight and top performance while serving with character and purpose which upholds our mission with honor.

## VISION



As we maintain our leadership in construction, Palace Group is dedicated to expanding its presence in various sectors. We aim to forge robust partnerships with reputable national and international companies, particularly in the fields of oil and gas, services and infrastructure. In the pursuit of this, we founded Petroleum Palace Group LLC in 2015, serving as our oil and gas industrial arm.

# GROUP STRUCTURE

## Palace Group Companies

Palace Group Construction	<a href="#">SEE MORE</a>	Palace Luxury Living Real Estate Development
Palace Group Electromechanical	<a href="#">SEE MORE</a>	Petroleum Palace Group
Palace Group Fit-out		Palace Group (offshore) International Trading
Palace Group Joinery		Palace Group Investments

# DIVISIONS



## CIVIL WORKS

Our dedicated civil team, boasting over 25 years of experience, consistently delivers outstanding performance throughout all construction phases, up to the most sophisticated structural solutions.

In high-end projects, the quality of our concrete work is pivotal, as it directly impacts the subsequent tasks, demonstrating Palace Group's unwavering commitment to excellence.



## ELECTROMECHANICAL

Palace Group's prominent MEP contracting division offers a comprehensive range of services, including:

- Mechanical systems
- Electrical and power distribution solutions
- Plumbing services
- Air conditioning and ventilation treatments
- Industrial and process expertise
- Plant and machinery installation
- Fire detection and alarm systems
- Small power and control systems
- Data, structured cabling, and communication installations



## INTERIOR FIT-OUT

Palace Group's interior fit-out division was established in response to the increasing need for high quality interior fit-out projects. Working in parallel with the company's construction division, the interior fit-out team actively seeks strategic clients and opportunities. Our approach is highly adaptable, crafting contracts to precisely match the project, client, and consultants. Backed by a versatile, multi-disciplined support team, Palace Group's interior fit-out division excels at offering comprehensive assistance, especially on projects with intricate engineering challenges.

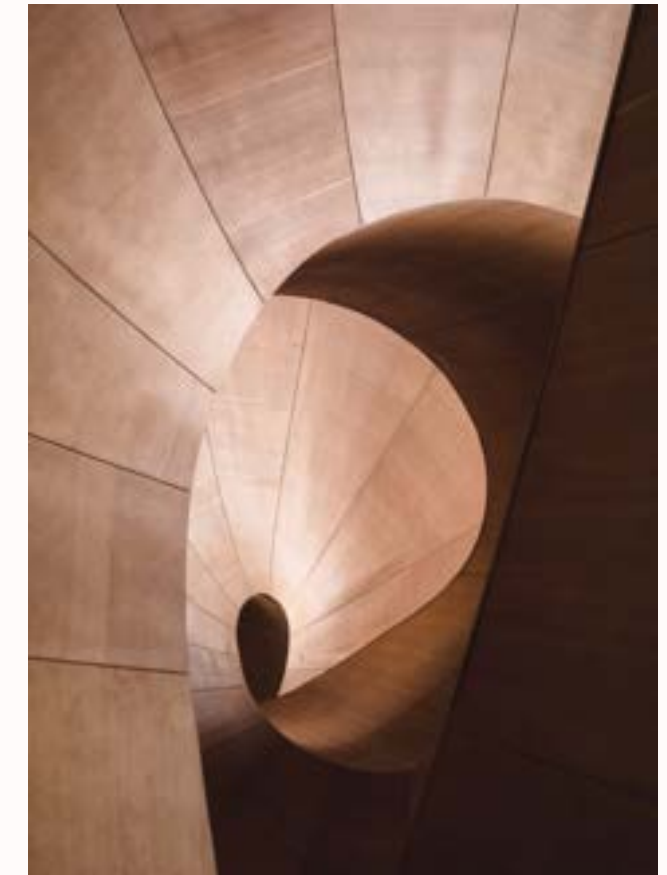

## JOINERY

As premium joinery specialists, we are dedicated to crafting and installing exceptional products for luxury properties. We work with the highest quality of materials, including timber, glass, leather, stone, metal, textiles and more. Each project is managed by a top-class team comprising micromanagement in procurement engineering and execution expertise - all trained to deliver excellent client support.

# SERVICES + PROVISIONS

“Quality is the best business plan.” John Lasseter



Dedicated to the full scope of turnkey development projects, Palace Group provides all engineering stages from site analysis, feasibility studies, preliminary design studies up to general construction, including high end fit-out projects. Our unwavering dedication to client satisfaction is our driver for delivering excellent services across various construction sectors. Our services adhere to rigorous international standards.



Trust in us has been developed through 20 years of successful achievements: our unwavering commitment to upholding the highest quality and standards, our investment in the latest technologies and equipment, and our proven ability to deliver fast-track projects.



Palace Group boasts a full team of experienced engineers and superintendents, complimented by an arsenal of high-tech equipment. This combination enables us to swiftly meet the demands of diverse and complex projects and timelines.



# PROJECTS

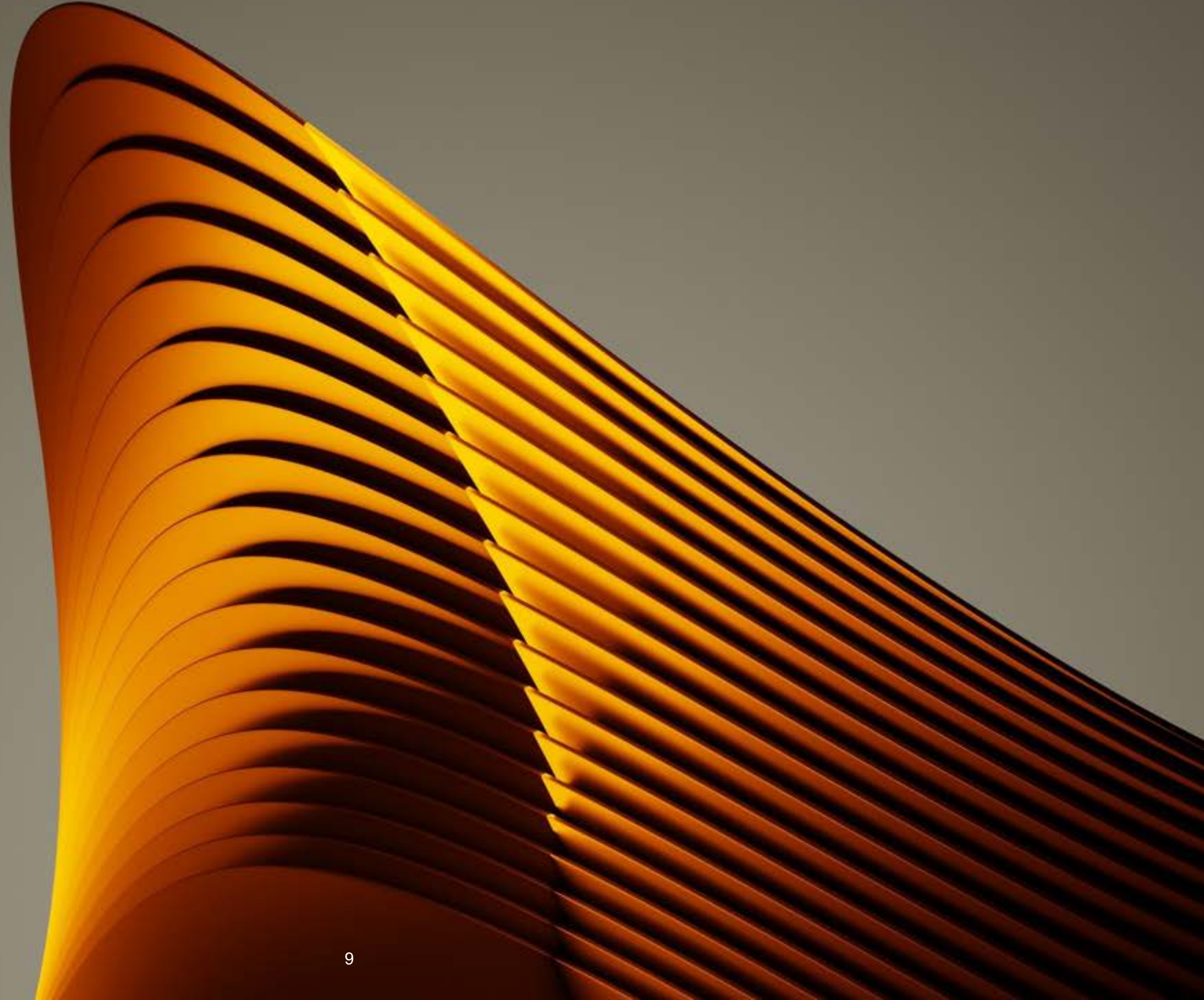

La Mer. A pristine peninsula flanked by sea and skyline.





## GEODE, LA MER PENINSULA

## ABOUT PROJECT



Nestled within the exclusive La Mer Peninsula, Geode is a signature mansion on a unique waterfront plot at the heart of Dubai, harmoniously bridging land and sea.

Designed to blur the boundaries between indoor and outdoor living, an intricate arrangement of formal and family living spaces unfolds around a lush courtyard, the green heart of the house. This lively garden haven prompts a natural flow around it, seeps between living units, and creates passageways with stunning views to the landscape and the sea beyond.

Inspired by the natural mineral beauty of crystals, this sculpture house features six luxurious bedroom suites, indoor and outdoor pools, several lounges and entertainment spaces, a gym, spa, cigar lounge, wine cellar, vast service areas, and a rooftop lounge with 360° views of the Arabian Gulf, Burj Khalifa, and Downtown Dubai.





# NAUTILE, LA MER PENINSULA

## ABOUT PROJECT



Adjacent to Geode, Nautila is designed with a seamless flow for its residents, connecting interior spaces while offering glimpses and openings to the surrounding landscape. Gently curved surfaces order both sides of the villa, and house a sequence of gardens and water features, sculpted in harmony with nature.

Nautila enjoys airy, well-lit interiors that frame captivating views of the outdoor gardens and ocean beyond, where nature and modern living converge. It offers six luxurious bedroom suites, double-height expansive living areas, indoor and outdoor pools, a gym, spa, cigar lounge, wine cellar, service areas, and a rooftop lounge with 360° views of the Arabian Gulf, Burj Khalifa, and Downtown Dubai.









## CRAFT, LA MER PENINSULA

## ABOUT PROJECT



A breathtaking mansion designed to the highest standards, Craft is a masterpiece that offers a blend of beauty and functionality in the heart of La Mer Peninsula.

This property boasts five luxurious bedroom suites and a variety of lavish amenities, including a spa, gym, a rooftop lounge with a plunge pool and stunning views of Burj Khalifa, and various entertainment spaces, redefining the essence of refined living.







# REFLECTIONS, LA MER PENINSULA

## ABOUT PROJECT



A breathtaking duo meticulously designed to the highest standards, Reflections are paired masterpieces that offer a blend of beauty and functionality in the heart of La Mer Peninsula.

Each property boasts five luxurious bedroom suites and a variety of lavish amenities, including a spa, gym, a rooftop lounge with a plunge pool and stunning views of Burj Khalifa, and various entertainment spaces, redefining the essence of refined living.









SERENITY, LA MER PENINSULA

## ABOUT PROJECT



A luxurious four-bedroom property featuring impeccable finishes and an inviting outdoor oasis with a pristine pool. Every corner of this uniquely crafted residence exudes comfort and sophistication, offering a perfect lifestyle of refined elegance.

The villa epitomizes a timeless unity, where architecture and nature converge to create a sanctuary of tranquillity and luxury.









# VELA, LA MER PENINSULA





## ABOUT PROJECT



This elegant five-bedroom villa is a masterpiece of minimalist beauty and natural integration, nestled within the embrace of lush greenery. Architecturally elegant with distinctive curves and double-height spaces, the dwelling balances grandeur with spaciousness.

Expansive sliding windows connect each floor to large balconies, offering seamless outdoor access, including a serene garden with an elegant pool. Residents can enjoy a breathtaking skyline view from the rooftop, overlooking Burj Khalifa and Downtown Dubai.









Jumeirah Bay Island. Seclusion, with world class amenities.



# SYMPHONY, JUMEIRAH BAY ISLAND

## ABOUT PROJECT



This exquisite waterfront mansion boasts 40,000 sqft that merges luxury amenities with the serene beauty of its picturesque surroundings. A private oasis set in the heart of Dubai, this six-bedroom property is meticulously crafted to offer luxurious yet serene living with direct beach access. With curved terraces and rooftops, it embraces the sea across and frames the towering Dubai skyline.

A unique arrival is highlighted by a sequence of water features creating a refreshing promenade. It starts from an inviting reflecting pond poised just at the entrance, through a series of pools nestled within the living areas, crossing below a stunning rooftop pool and culminating with an infinity pool with unobstructed views towards the azure sea. Lavish amenities such a spa, sauna, wine cellar, and a rooftop lounge elevate the art of living in this elegant private property to an extraordinary level.











MV08, JUMEIRAH BAY ISLAND

## ABOUT PROJECT



A coastal gem, this 5-bedroom property is perched directly on the sea's edge where breathtaking views stretch endlessly.

With a stunning location on the most exclusive island in Dubai, meticulous attention to detail and a wealth of lavish amenities, this home exemplifies luxury living in a tranquil, seaside paradise.



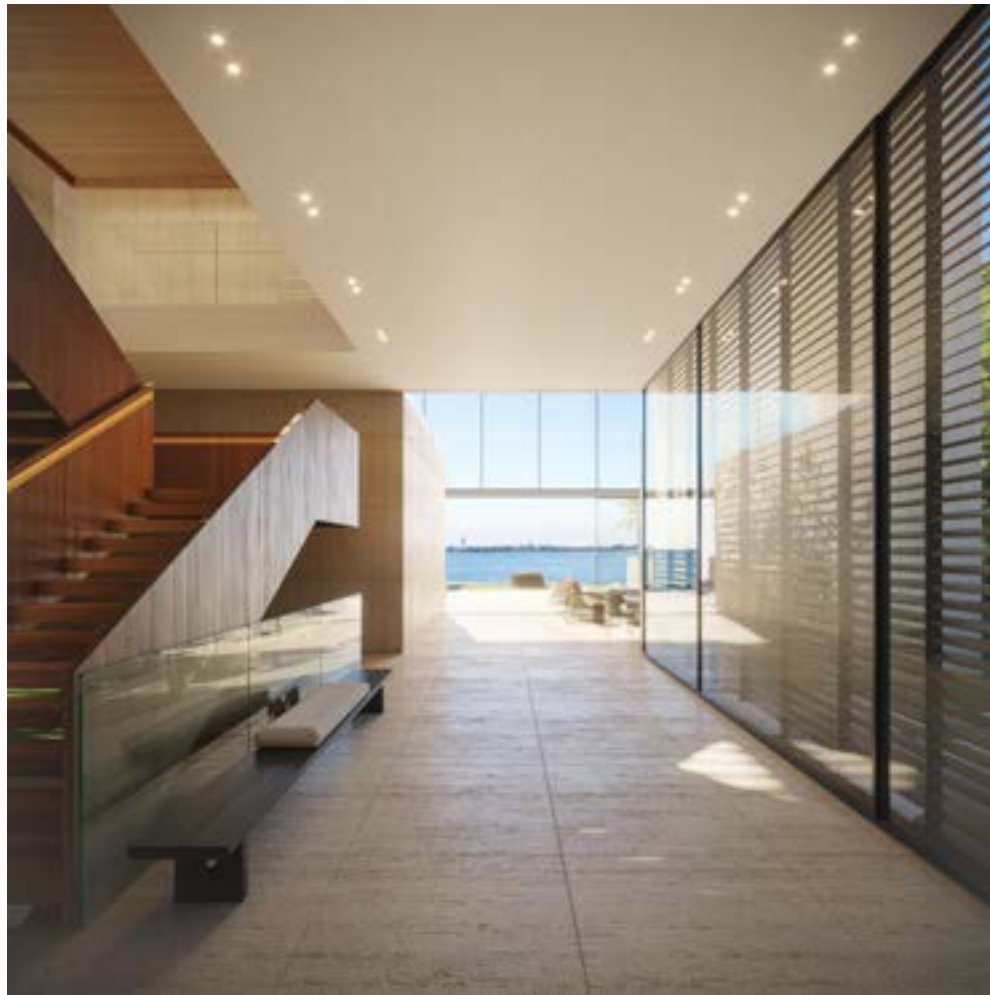











# MV18, JUMEIRAH BAY ISLAND

## ABOUT PROJECT



Nestled by the water in central Dubai, this exquisite property emanates an understated elegance.

With its tasteful features and serene surroundings, it offers a tranquil and refined lifestyle.



MV37, JUMEIRAH BAY ISLAND

## ABOUT PROJECT



This elegant waterfront property in a prime location in central Dubai exudes sophistication and grace. Its serene setting and tasteful amenities make it a perfect haven for those seeking a refined and tranquil living experience.











MV38-39, JUMEIRAH BAY ISLAND

## ABOUT PROJECT



An enchanting waterfront villa, reminiscent of a dreamy and peaceful resort, spanning two adjacent plots in the most exclusive location in Dubai.







# MV47, JUMEIRAH BAY ISLAND

## ABOUT PROJECT



This waterfront estate, with its direct beach access and breathtaking sea views, offers the epitome of luxury living. Featuring an array of resort-like amenities, including a pristine pool, a lavish spa, wine cellar, and a rooftop retreat, it promises a lifestyle of unparalleled opulence.











MV68-69, JUMEIRAH BAY ISLAND

## ABOUT PROJECT



This expansive villa offers a haven of relaxation with its lush landscaping and a serene pool area.

Designed for ultimate leisure, it seamlessly blends natural beauty and luxurious amenities to create a perfect retreat.







LV18-19, JUMEIRAH BAY ISLAND

## ABOUT PROJECT



This remarkable beachfront estate sprawls across two coveted plots in the most exclusive location in central Dubai.

Boasting an endless array of lavish amenities, it defines grandeur and sets a new standard for luxurious living in the heart of the city.



# JARDIN SUR MER, JUMEIRAH BAY ISLAND



## ABOUT PROJECT



With unobstructed views of the Arabian Sea, this palatial six-bedroom mansion redefines true luxury with its impeccable finishes and seamless integration of indoor-outdoor living.

Offering direct beach access and a stunning poolside sanctuary, this property embodies the epitome of elegance and exclusivity. Its expansive amenities – including a state-of-the-art gym, a serene spa, and a rooftop lounge with 360° view of the Arabian Sea and Downtown Dubai – create an idyllic haven for the ultimate coastal lifestyle.







LV50, JUMEIRAH BAY ISLAND

## ABOUT PROJECT



A waterfront masterpiece, this grand property in central Dubai combines unparalleled beauty with lavish amenities.

From its sparkling pool and spa to the wine cellar and a rooftop overlooking downtown Dubai, it represents the pinnacle of resort-style luxury living.





## COURTYARD

## ABOUT PROJECT



Nestled within the lush green expanse of Dubai Hills, this 5-bedroom residence epitomizes true luxury living in a verdant oasis. It offers lavish amenities throughout, including a serene spa and a stunning outdoor pool.

Courtyard seamlessly combines the beauty of nature with extravagant comfort, making it a true haven to escape the hustle and bustle of central Dubai.













## KINGSTON VILLA







# BAKER VILLA



## ABOUT PROJECT



An embodiment of true modern opulence, this ultra-luxury villa spans an impressive 87,000 sqft, featuring several formal and family spaces, luxurious amenities and an array of pools for ultimate relaxation and rejuvenation.











# KMV VILLA

## ABOUT PROJECT



This luxurious 30,000 sqft property in central Abu Dhabi epitomizes resort-style living, boasting a private pool, spa, and all the quintessential amenities of a lavish villa.

A true oasis in the heart of the city, it offers the ultimate in comfort and relaxation.







# ATRAD VILLA

## ABOUT PROJECT



Nestled on a spacious plot, this 42,000 sqft property in central Abu Dhabi captivates with its magnificent landscaping, creating a stunning outdoor oasis. Inside, the home is adorned with elegant interior finishes.





# JUMEIRAH 3 PRIVATE VILLA

## ABOUT PROJECT



This expansive 30,000 sqft villa in the heart of Jumeirah features elegant finishes and a private pool that enhances its appeal.

Its prime location in this prestigious neighborhood offers a lifestyle of convenience and exclusivity.







# DUBAI GARDEN BUILDING 1





## DUBAI GARDEN BUILDING 2

## ABOUT PROJECT



### Articles

- Arabian Business

[SEE HERE](#)

- Construction Week

[SEE HERE](#)









# RITZ CARLTON





# THE CLIFFS, DUBAI CANAL













# CONTACT US



## ABU DHABI

MUSSAFAH  
PLOT 56 - M26  
OFFICE 11  
P.O. BOX 113994

T: +971 2 5502558  
F: +971 2 5502559



## DUBAI

THE ONYX TOWER 2  
BARSHA HEIGHTS, DUBAI, UAE  
OFFICE 613-614  
P.O. BOX 121604

T: +971 4 334 7878  
F: +971 4 334 7676



## SHARJAH

AL NAHDA  
MOHAMMED AL MULLA TOWER  
OFFICE 1301  
P.O. BOX 5744

OFFICE 614  
THE ONYX TOWER 2  
BARSHA HEIGHTS  
DUBAI, UAE  
P.O. BOX 121604

[CONTACT@PALACEGROUP.AE](mailto:CONTACT@PALACEGROUP.AE)

[WWW.PALACEGROUP.AE](http://WWW.PALACEGROUP.AE)

